

Chest freezer

SF-PC997(EX)-BF

-20°C

Thailand



Effective capacity
236L

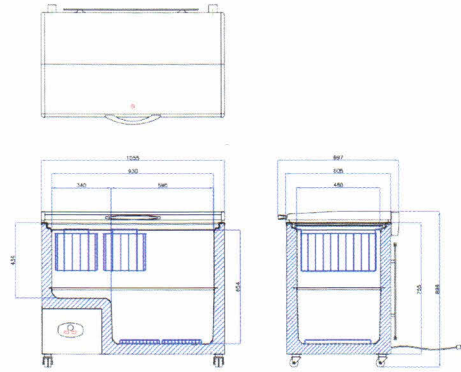

Model		SF-PC997(EX)-BF											
Operating temperature		-20°C (ambient temperature 32°C)					Compressor		Hermetic type				
Case body	Dimensions (mm)		W	D	H	Refrigeration system	Refrigerant			R134a			
		External	1055	697	896		Evaporator			Copper tube wrapped on inner liner			
	Internal	930	480	654	Condenser			Wire cond & Tube natural convection					
	Effective capacity (L)		236				Temperature control			Mechanical thermostat			
	Outer case material		Bake on acryl finish on steel sheet					Defrost type			Manual off-cycle defrost		
	Inner case material		HIPS & bake on acryl finish on steel sheet					Lighting		No			
	Door type		Bake on acryl finish on steel sheet					Weight (kg)		56.5			
	Basket		PE powder coated basket x 2					Electrical parameter		Power source	Operation power	Defrost power	
									1φ, 220V, 50-60Hz	ND	ND		

Chest freezer

SF-PC1497(EX)-BF

-20°C

Thailand

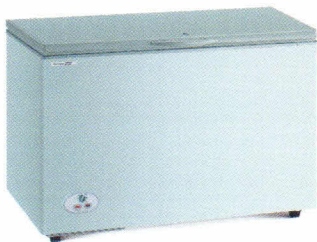

Effective capacity
357L

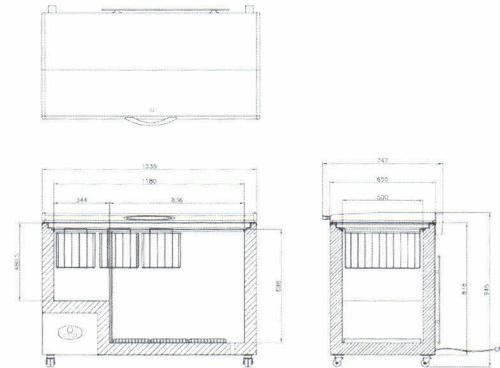

Model		SF-PC1497(EX)-BF											
Operating temperature		-20°C (ambient temperature 32°C)					Compressor		Hermetic type				
Case body	Dimensions (mm)		W	D	H	Refrigeration system	Refrigerant			R134a			
		External	1335	747	945		Evaporator			Copper tube wrapped on inner liner			
	Internal	1180	500	698	Condenser			Wire cond & Tube natural convection					
	Effective capacity (L)		357				Temperature control			Mechanical thermostat			
	Outer case material		Bake on acryl finish on steel sheet					Defrost type			Manual off-cycle defrost		
	Inner case material		HIPS & bake on acryl finish on steel sheet					Lighting		15W x 1			
	Door type		Bake on acryl finish on steel sheet					Weight (kg)		74			
	Basket		PE powder coated basket x 3					Electrical parameter		Power source	Operation power	Defrost power	
									1φ, 220V, 50-60Hz	ND	ND		